

FIXTURE HANGING

Fixture hanging equipment included with unit for necessary mounting.

1. Attach the ring bolt to the reflector support frame(a).
2. Attach the carbiner on the steel wire hanger to ballast hanging holes(b).
3. Hang the fixture in the desired location(c).

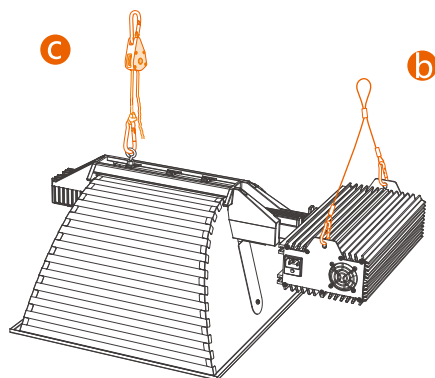
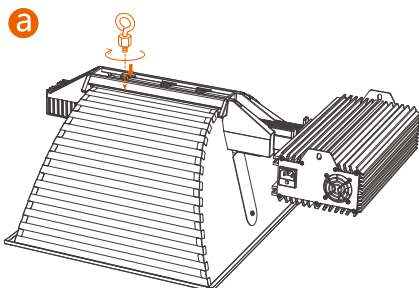

SUITABLE LAMPS

The Nanolux DEFNC 1000W 4X4 fixture is designed and tested to drive High Pressure Sodium (HPS) lamps. Using regular 1000W HPS lamps can cause damage to your ballast and lamp.



MAINTENANCE

There are no serviceable parts inside the luminaire. Opening the luminaire will void warranty. Keep housing clean from dust and dirt with a dry or damp cloth to ensure optimal cooling. When using a damp cloth disconnect from the power first. Check your electrical connections regularly.



WARRANTY

Nanolux Technology warrants the mechanical and electronic components of this product to be free of defects in material and workmanship if used

under normal operating conditions for a period of three (3) years from the original date of purchase. If the product shows any defects within this period and that defect is not due to user error or improper use Nanolux Technology shall, at its discretion, either replace or repair the product using suitable new or refurbished parts. For Nanolux DE HPS lamps and reflector the warranty period is one (1) year from the original date of purchase. In case Nanolux decides to replace the entire product, this limited warranty shall apply to the replacement ballast for the remaining initial warranty period, i.e. three (3) years from the date of purchase of the original product. For service return the ballast to your shop with the **original sales receipt**.

For more information about Nanolux product please visit nanoluxtech.com



PATENTED PRODUCTS, COUNTERFEITING NOT ALLOWED.

Designed by NANOLUX in California
Made in China

OPERATING MANUAL

DIGITAL ELECTRONIC

BALLAST

DEFNC 1000W 4X4

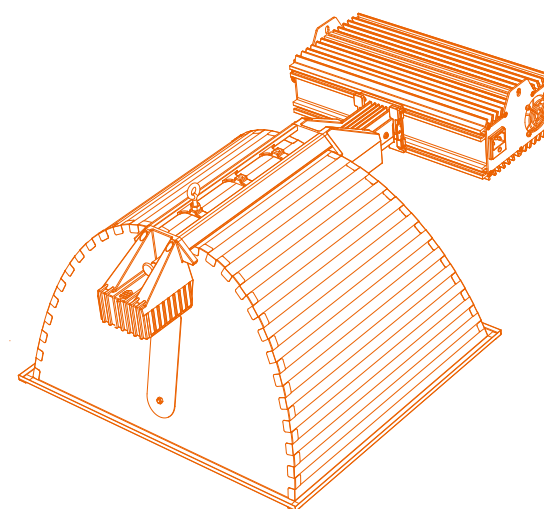

ADJUSTABLE
POWER+
SOFT DIM

NANOLUX DE
www.nanoluxtech.com
Illuminating Your Grow

PLEASE READ THESE INSTRUCTIONS FIRST BEFORE INSTALLATION

Congratulations on the purchase of your new Nanolux DEFNC 1000W 4X4 fixture. We have done everything to insure a long operating life and safe product but the installation and use of the ballast is the responsibility of the user. Incorrect use or installation can lead to failure and damage to the ballast. Damage to the fixture and electronic circuitry as a result of incorrect installation or use revokes your warranty. Read this manual carefully before installing your fixture.

TECHNICAL SPECIFICATIONS

Model	DEFNC 1000W 4*4
	Fan
Input Voltage	120VAC/208VAC/220VAC/240VAC/277VAC(Optional)
Output Voltage	200VAC-300VAC
Input Frequency	50Hz-60Hz
Output Power	1200W Max
Power Factor	≥0.99
Crest Factor	< 1.7
THD	≤10%
Dimming	600W-660W-750W-825W-1000W-1200W
Strike Lamp	DE HPS1000W/DE MH1000W
Protection Function	Over Temperature;Over/Under Voltage;Open/Short Circuit
Size (L*W*H)	463*665*260mm 18.2*26.1*10.2 inch
Weight	5.93 kgs 13.07 lbs

REFLECTOR/LAMP HOLDER INSTALLMENT

The Nanolux DEFNC 1000W 4X4 fixture should be handled with care. If it is damaged in any way you should replace it. We recommend to change the reflector every year for optimal results. Replacement reflectors are available through your Nanolux Technology reseller.

To replace the reflector, you must remove the lamp first as described above in how to install the lamp. Let the reflector cool down if it has been operating to prevent an injury. At the end of the reflector bracket, you will find a chrome knob. Pull the knob outward to release the pin holding the reflector in place (a-1). The reflector can then be pulled away from the ballast end of the bracket to remove it from the two pins holding it in place (a-2 & a-3). When inserting the new reflector, slide it into the two pins (a-2 & a-3) and then release the pin (a-1) to secure it in place.

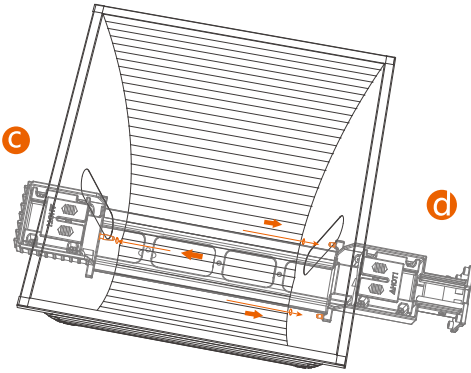
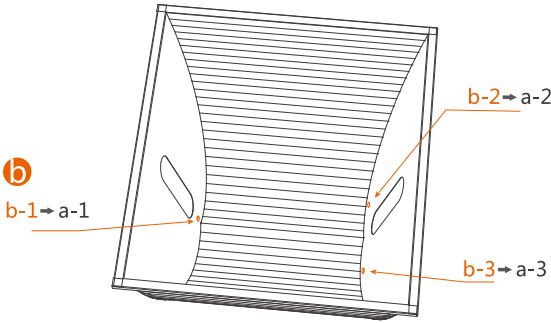
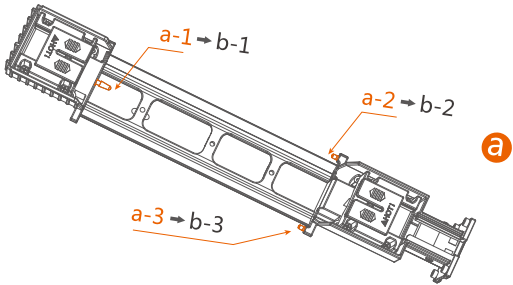

INSTALL FIXTURE ON BALLAST

1. Shut off the power.
2. Hold the fixture from its base and plug in the fixture by inserting terminal into the socket.
3. Slide the fast mounting clips to the fixture base groove until they are in place to hold the fixture.
4. Press the fast mounting lever to lock in place.
5. Confirm the fixture is installed on ballast properly and is not loose.

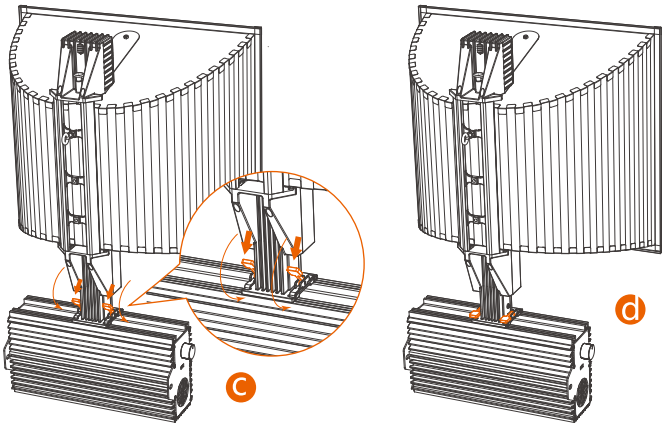
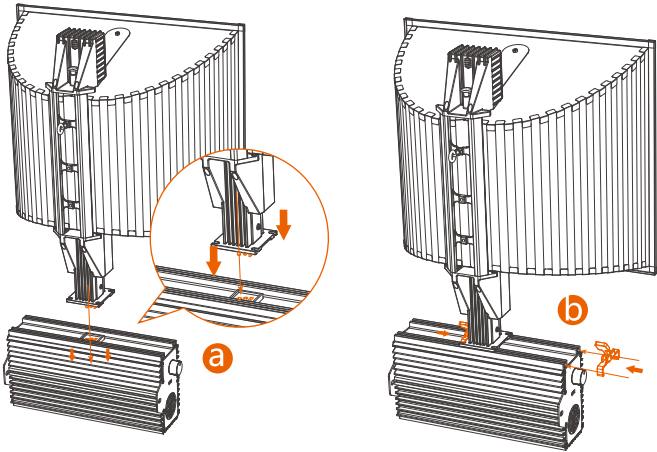

HOT RESTRIKE

CAUTION:

- Always install the lamp before connecting your luminaire to mains.
- Allow lamp to cool 30 minutes before restarting (hot restrike).
- When changing the lamp always disconnect the luminaire from mains by removing the mains plug. Let the lamp and reflector cool down for 30 minutes before changing as they are very hot. When replacing a defect lamp without disconnecting mains the lamp will not start. Disconnecting the power will restart the ballast.
- DO NOT touch hot Ceramic socket.
- Make sure the DE lamp wires are correctly within the socket copper wire clamps.
- Make sure to fully close the ceramic socket to the correct position and keep the socket clean to provide proper function.
- Fragile !! Be careful and do not exert excessive force while moving the ceramic slider on the ceramic socket connection
- Keep away from water.

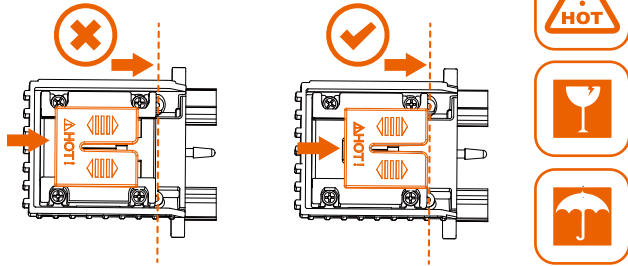

LAMP REPLACEMENT

TO TAKE OUT A LAMP:

- DISCONNECT THE MAINS FIRST
- Open the lamp holders by sliding them outward. The lamp is held by a metal spring at each side, though it is recommended to hold the lamp while opening the lamp holders to prevent the lamp from falling.

TO INSTALL A NEW LAMP:

- DISCONNECT FROM MAINS FIRST
- Make sure the lamp is clean, wear cotton gloves and clean the lamp after installation with a dry soft cloth. Never use detergents to clean a lamp, use pure alcohol or whip clean with a dry clean soft cloth.
- Make sure the end wires are straight.
- Open the lamp holders by sliding them outward. Press the lamp in the fitting until the metal springs hold the lamp, with the glass vacuum seal pointed downward.
- Close the lamp holders by sliding them inward.
- Wipe the lamp with a clean soft cloth.
- Be sure not to touch the reflective material of the reflector with your bare hands.

